

B.M.Europe

electrical water pump

A pump for pumping smaller quantities of water from a waterbed efficiently and in a properly controlled manner.

Capacity: \pm 6 litres per minute.

Instructions for use.

1. Unscrew the topside (A) of the pump.
2. Insert two type D batteries (not supplied with the pump) in the battery holder (B)
3. Screw the topside (A) of the pump back on.
4. Connect the drain hose (not supplied with the pump) to the drain pipe (C)
5. Press the drain pipe (C) firmly on the outlet (D) of the pump
6. Pull the filler opening (E) of the waterbed out and remove the exterior and interior cap

To pump water out of waterbed

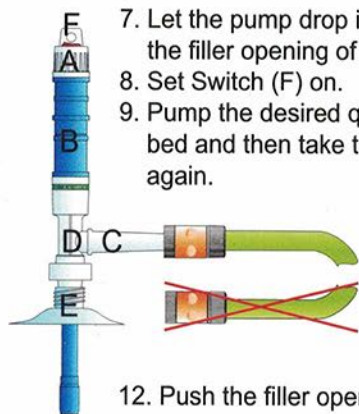

7. Let the pump drop in the filler opening and press on the filler opening of the waterbed.
8. Set Switch (F) on.
9. Pump the desired quantity of water from the waterbed and then take the pump out of the waterbed again.
10. Vent the waterbed properly, if necessary, with our air extractor.
11. Put the interior and exterior cap back on to seal the waterbed.
12. Push the filler opening again in the waterbed.

To pump water into a waterbed

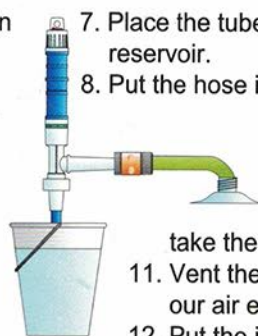

7. Place the tube of the pump in the water of the water reservoir.
8. Put the hose in the valve of the waterbed.
9. Set Switch (F) on.
10. Pump the desired quantity of water from the waterreservoir in the waterbed. Set the Switch (F) of and take the pump out of the waterreservoir.
11. Vent the waterbed properly, if necessary, with our air extractor.
12. Put the interior and exterior cap back on to seal the waterbed.
13. Push the filler opening again in the waterbed.